

PRODUCT DATASHEET

SP DRIVER DALI 8W

SP DRIVER | Professional DALI driver for LEDVANCE 8W SPOTs



Areas of application

- DALI installations

Product benefits

- DALI driver with individual luminaire current set-up already installed
- Extended services such as energy monitoring and remote maintenance possible with DALI versions
- Easy replacement of external driver thanks to plug with bayonet lock

Product features

- IoT-ready driver with DALI-2 technology
- Push DIM function for dimming and switching directly on a pushbutton
- Suitable for emergency central battery installations acc. to EN 60598-2-22
- Twist & lock connector for ease of installation



TECHNICAL DATA

Electrical data

Nominal wattage	8.00 W
Nominal voltage	220...240 V
Mains frequency	50/60 Hz
Max. number of luminaires per miniature circuit breaker B16	130
Power factor λ	0.90
Protection class	II

Dimensions & Weight

Length	120.00 mm
Width	53.00 mm
Height	30.00 mm
Product weight	100.00 g

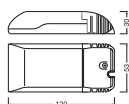

SP DRIVER DALI 8W

Materials & Colors

Product color	Grey
Body material	Polycarbonate (PC)
Mercury content	0.0 mg

Application & Mounting

Ambient temperature range	-20...+40 °C
Temperature range at storage	-42...+80 °C
Type of protection	IP20
Dimmable	Yes
Type of dimming	DALI2

Control gear

Output current	180 mA
----------------	--------

Emergency lighting

Wattage in emergency operation mode	3,0 W
Luminous flux in emergency operation mode	120 lm

Certificates & Standards

Standards	CE / UKCA / EAC
-----------	-----------------

Additional product data

Product remark	Available from June 2023
----------------	--------------------------





EQUIPMENT / ACCESSORIES

- Can only be used with LEDVANCE SPOTs 8 W (CC 180mA)

Safety advice

- Do not cover with any thermal insulation material!

DOWNLOAD DATA

Documents and certificates		Document name
	User Instruction	UI SP FIX P and SP FIX ADJ
	User Instruction	UI SP DK FIX P
	User Instruction	UI SP FP FIX P
Tender texts		Document name
	Tender documents	SP DRIVER DALI 8W-en

LOGISTICAL DATA

Product code	Packaging unit (Pieces/Unit)	Dimensions (length x width x height)	Gross weight	Volume
4099854089558	Folding box 1	35 mm x 220 mm x 62 mm	205.00 g	0.48 dm ³
4099854089565	Shipping box 4	227 mm x 155 mm x 74 mm	1025.00 g	2.60 dm ³

The mentioned product code describes the smallest quantity unit which can be ordered. One shipping unit can contain one or more single products. When placing an order, for the quantity please enter single or multiples of a shipping unit.

ADDITIONAL CATALOG INFORMATION

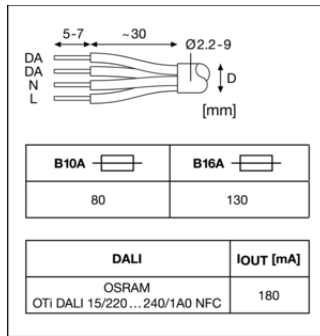
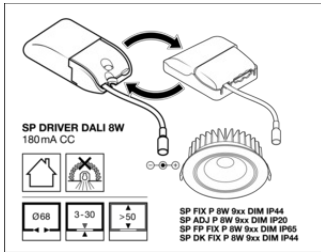

DISCLAIMER

Subject to change without notice. Errors and omission excepted. Always make sure to use the most recent release.