

|                           |                         |   |
|---------------------------|-------------------------|---|
| 10074000                  | <b>DATA SHEET</b>       |  |
| Valid from:<br>17.09.2018 | <b>EPIC® H-B 16 SGR</b> |   |

## Description

- The housing standard.
- Wide choice for all applications.



## General Characteristics

|                              |  |
|------------------------------|--|
| Series                       | H-B 16                                   |
| Version                      | Surface mount base PG 21                 |
| Cable entry                  | 1  |
| Locking                      | Double lever                             |
| Protection (DIN EN 60529)    | IP 65 (latched)                          |
| Protection (NEMA 250, UL50E) | 4, 12 (latched)                          |
| Temperature Range            | -40°C to +100°C, short term up to +125°C |

## Materials and Surfaces

|         |                                      |
|---------|--------------------------------------|
| Housing | Aluminium alloy, powder-coated, grey |
| Bolt    | Heat-treatable steel, zinc-plated    |
| Lever   | Steel, zinc-plated                   |
| Sealing | NBR                                  |

## Approvals

|                            |      |
|----------------------------|------|
| VDE-Approval, VDE-REG.-Nr. | B437 |
|----------------------------|------|

## Standard

|                 |           |
|-----------------|-----------|
| Safety Standard | IEC 61984 |
|-----------------|-----------|

|   |                                       |             |
|---|---------------------------------------|-------------|
| Creator: MANA2/PDP<br>Released: IVSE1/PDP | Document: DB10074000EN<br>Version: 01 | Page 1 of 2 |
|---|---------------------------------------|-------------|

|                           |                   |   |
|---------------------------|-------------------|---|
| 10074000                  | <b>DATA SHEET</b> |  |
| Valid from:<br>17.09.2018 | EPIC® H-B 16 SGR  |   |

## Technical Drawings

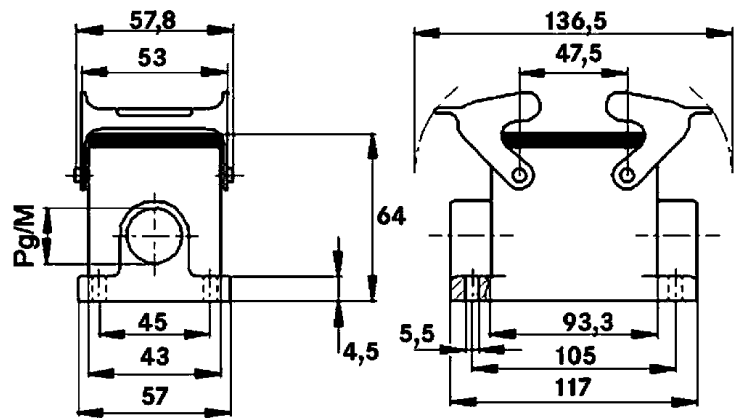

Automation



Industrial machinery and plant engineering



Mechanical resistance



Robust



Waterproof

### Info

Universal, robust metal housings size H-B 16

### Application range

Plant engineering  
Light & sound technology  
Plastics industry

### Remark

Photographs are not to scale and do not represent detailed images of the respective products.

|   |                                       |             |
|---|---------------------------------------|-------------|
| Creator: MANA2/PDP<br>Released: IVSE1/PDP | Document: DB10074000EN<br>Version: 01 | Page 2 of 2 |
|---|---------------------------------------|-------------|