

19036000	<b>DATA SHEET</b>	
Valid from: 17.09.2018	<b>EPIC® H-B 10 SDR-BO</b>	

## Description

- The smallest housing with single and double lever.
- The right housing is available for every application.



## General Characteristics

Series	H-B 10
Version	Surface mount base M20 / M25 (Article 19036100)
Protection cover	Yes
Locking	Bolts for double lever
Cable entry	1
Protection (DIN EN 60529)	IP 65 (latched) IP 40 (cover closed)
Protection (NEMA 250, UL50E)	4, 12 (latched)
Temperature Range	-40°C to +100°C, short term up to +125°C

## Materials and Surfaces

Housing	Aluminium alloy powder-coated, grey
Cover	Zinc alloy powder-coated, grey
Bolt	Stainless steel
Profile Seal	NBR

## Approvals

VDE-Approval, VDE-REG.-Nr.	B437
----------------------------	------

## Standard

Safety Standard	IEC 61984
-----------------	-----------

Creator: MANA2/PDP Released: IVSE1/PDP	Document: DB19036000EN Version: 02	Page 1 of 2
---	---------------------------------------	-------------

19036000	<b>DATA SHEET</b>	
Valid from: 17.09.2018	EPIC® H-B 10 SDR-BO	

## Technical Drawings

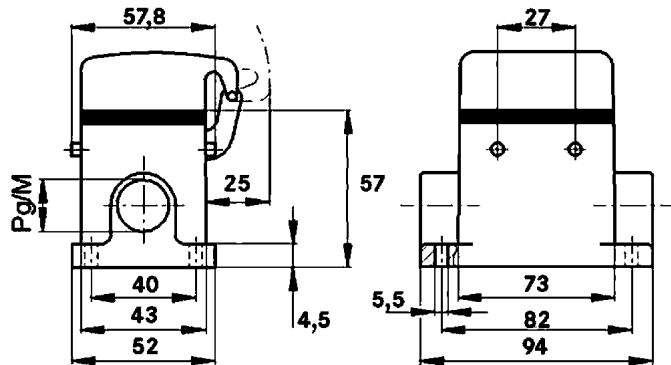

Automation

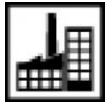

Industrial machinery and plant engineering



Mechanical resistance



Robust



Waterproof

### Info

Universal, robust metal housings size H-B 10

### Application range

Plant engineering  
Light & sound technology  
Plastics industry

### Remark

Photographs are not to scale and do not represent detailed images of the respective products.

Creator: MANA2/PDP Released: IVSE1/PDP	Document: DB19036000EN Version: 02	Page 2 of 2
---	---------------------------------------	-------------