

44423116	<b>DATA SHEET</b>	
Valid from: 03.11.2020	<b>EPIC® M17 SIGNAL G4</b>	

### Description:

Device connector for front wall mounting  
 SPEEDCON-Lock, M17  
 Number of pins: 8 or 17  
 Contact type: male/female, Crimp connection  
 Sealing: O-Ring axial  
 Shielded: yes  
 Central mounting



### Product variations:

Article number	Typ	Pin-arrangement	PU
44423118	female	8 Pin	5
44422116	male	8 Pin	5
44423119	female	17 Pin	5
44423117	male	17 Pin	5

### General characteristics:

Connector type	Device connector/ Panel plug
Number of pins	8 / 17
Connector lock	Speedcon
Mounting type	Central mounting M18x0,75 with counter nut
Termination method	Crimp termination
Upper temperature limit	+ 125 °C
Lower temperature limit	- 40 °C
Contacts, base material	CuZn (brass)
Contacts, surface	Au (gold)
Insert material	PA
Housing material	Nickel plated zinc die-casting
Sealing material	FPM
Protection class	IP 67
Pollution degree	3
Overvoltage category	III
Cycles of mechanical operation	>100

Creator: STKU3/PDP Released: IVSE1/PDP	Document: DB44423116EN Version: 03	Page 1 of 4
---	---------------------------------------	-------------

44423116	<b>DATA SHEET</b>	
Valid from: 03.11.2020	<b>EPIC® M17 SIGNAL G4</b>	

## Version 8 Pin

### Electrical characteristics:

Rated voltage	48V AC / 74V DC
Rated impulse voltage	1500 V
Rated current (25°C)	3,6 A
Contact diameter	1 mm
Termination cross-section	0,06 mm <sup>2</sup> – 1,0 mm <sup>2</sup>

### Pin-arrangement:

Female

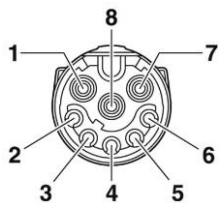

Male

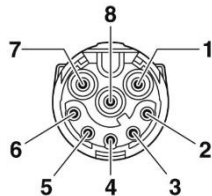

### Fitting female contacts (contacts must be ordered separately)



Lapp Art. No.	Description
44423122:	Crimp contact, drilled, contact diameter: 1 mm, termination cross-section: 0,06 mm <sup>2</sup> ...0,25 mm <sup>2</sup>
44423123:	Crimp contact, drilled, contact diameter: 1 mm, termination cross-section: 0,34 mm <sup>2</sup> ...0,5 mm <sup>2</sup>
44423124:	Crimp contact, drilled, contact diameter: 1 mm, termination cross-section: 0,5 mm <sup>2</sup> ...1 mm <sup>2</sup>

### Fitting male contacts (contacts must be ordered separately)



Lapp Art. No.	Description
44423130:	Crimp contact, drilled, contact diameter: 1 mm, termination cross-section: 0,06 mm <sup>2</sup> ...0,25 mm <sup>2</sup>
44423131:	Crimp contact, drilled, contact diameter: 1 mm, termination cross-section: 0,34 mm <sup>2</sup> ...0,5 mm <sup>2</sup>
44423132:	Crimp contact, drilled, contact diameter: 1 mm, termination cross-section: 0,5 mm <sup>2</sup> ...1 mm <sup>2</sup>

Creator: STKU3/PDP Released: IVSE1/PDP	Document: DB44423116EN Version: 03	Page 2 of 4
---	---------------------------------------	-------------

44423116	<b>DATA SHEET</b>	
Valid from: 03.11.2020	<b>EPIC® M17 SIGNAL G4</b>	

## Version 17 Pin

### Electrical characteristics:

Rated voltage	48V AC / 74V DC
Rated impulse voltage	1500 V
Rated current (25°C)	3,6 A
Contact diameter	0,6 mm
Termination cross-section	0,06 mm <sup>2</sup> – 0,5 mm <sup>2</sup>

### Pin-arrangement:

#### Female

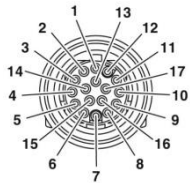

#### Male

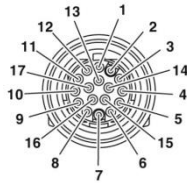

### Fitting female contacts (contacts must be ordered separately)



Lapp Art. No.	Description
44423125:	Crimp contact, drilled, contact diameter: 0,6 mm, termination cross-section: 0,06 mm <sup>2</sup> ...0,25 mm <sup>2</sup>
44423126:	Crimp contact, drilled, contact diameter: 0,6 mm, termination cross-section: 0,06 mm <sup>2</sup> ...0,34 mm <sup>2</sup>
44423127:	Crimp contact, drilled, contact diameter: 0,6 mm, termination cross-section: 0,34 mm <sup>2</sup> ...0,5 mm <sup>2</sup>

### Fitting male contacts (contacts must be ordered separately)



Lapp Art. No.	Description
44423133:	Crimp contact, drilled, contact diameter: 0,6 mm, termination cross-section: 0,06 mm <sup>2</sup> ...0,25 mm <sup>2</sup>
44423134:	Crimp contact, drilled, contact diameter: 0,6 mm, termination cross-section: 0,06 mm <sup>2</sup> ...0,34 mm <sup>2</sup>
44423135:	Crimp contact, drilled, contact diameter: 0,6 mm, termination cross-section: 0,34 mm <sup>2</sup> ...0,5 mm <sup>2</sup>

Creator: STKU3/PDP Released: IVSE1/PDP	Document: DB44423116EN Version: 03	Page 3 of 4
---	---------------------------------------	-------------

44423116	<b>DATA SHEET</b>	
Valid from: 03.11.2020	EPIC® M17 SIGNAL G4	

**Drawings and dimensions of the connector:**

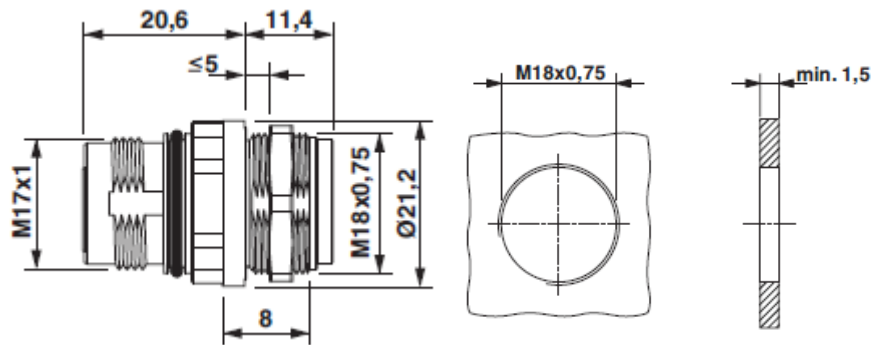

**Needed holes and breakthroughs at the housing:**

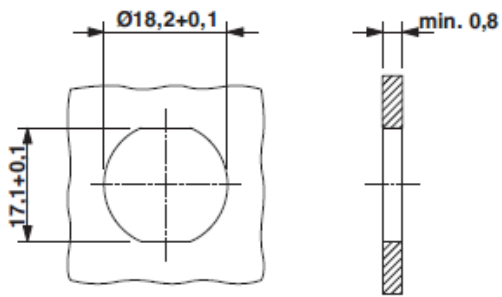

**Application range:**

Plant engineering; measurement and control technology; apparatus construction

**Remark:**

Photographs are not to scale and do not represent detailed images of the respective products.

Creator: STKU3/PDP Released: IVSE1/PDP	Document: DB44423116EN Version: 03	Page 4 of 4
---	---------------------------------------	-------------