

# EPIC® M17 POWER A3

L44423080DE\_EN  
2016330

U.I. Lapp GmbH  
Schulze-Delitzsch-Straße 25 • D-70565 Stuttgart  
www.lappgroup.com

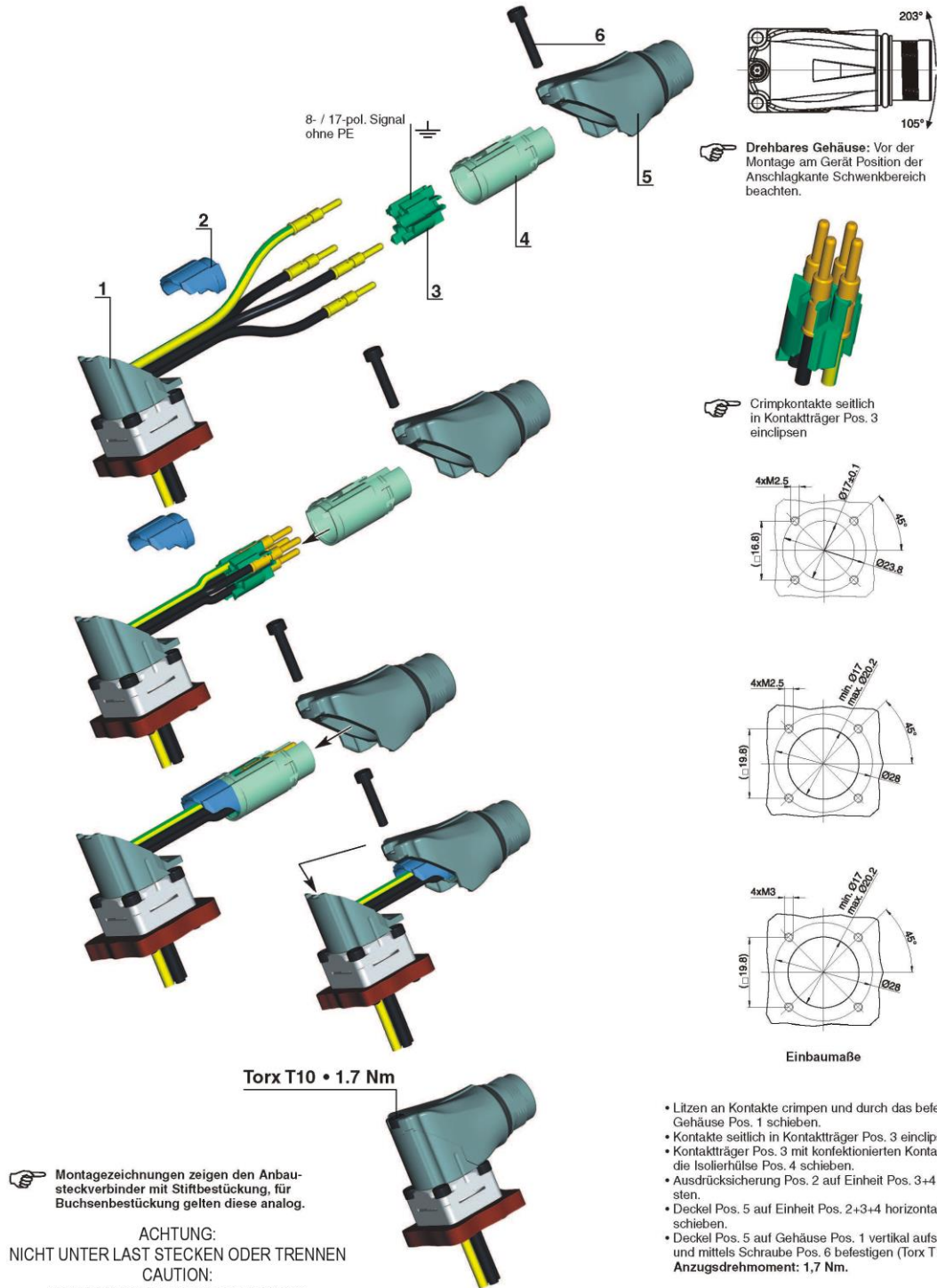

Torx T10 • 1.7 Nm

Montagezeichnungen zeigen den Anbausteckverbinder mit Stiftbestückung, für Buchsenbestückung gelten diese analog.

ACHTUNG:  
NICHT UNTER LAST STECKEN ODER TRENNEN  
CAUTION:  
NOT FOR CURRENT INTERRUPTING  
ATTENTION:  
NE PAS UTILISER POUR COUPER LE COURANT

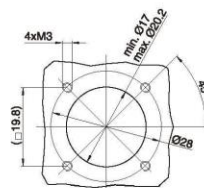
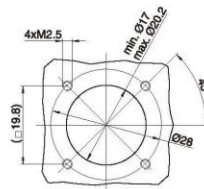
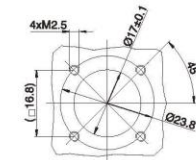
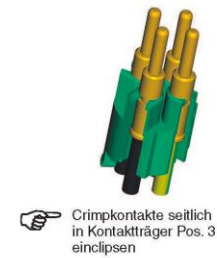
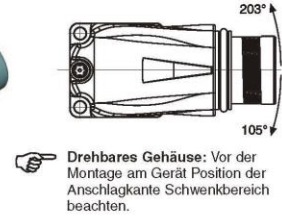

Einbaumaße

- Litzen an Kontakte crimpsen und durch das befestigte Gehäuse Pos. 1 schieben.
- Kontakte seitlich in Kontaktträger Pos. 3 einclippen.
- Kontaktträger Pos. 3 mit konfektionierten Kontakten in die Isolierhülse Pos. 4 schieben.
- Ausdrücksicherung Pos. 2 auf Einheit Pos. 3+4 verrasten.
- Deckel Pos. 5 auf Einheit Pos. 2+3+4 horizontal aufschieben.
- Deckel Pos. 5 auf Gehäuse Pos. 1 vertikal aufsetzen und mittels Schraube Pos. 6 befestigen (Torx T10), Anzugsdrehmoment: 1,7 Nm.

# EPIC® M17 POWER A3

L44423080DE\_EN  
2016330

U.I. Lapp GmbH  
Schulze-Delitzsch-Straße 25 • D-70565 Stuttgart  
www.lappgroup.com

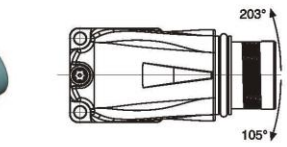
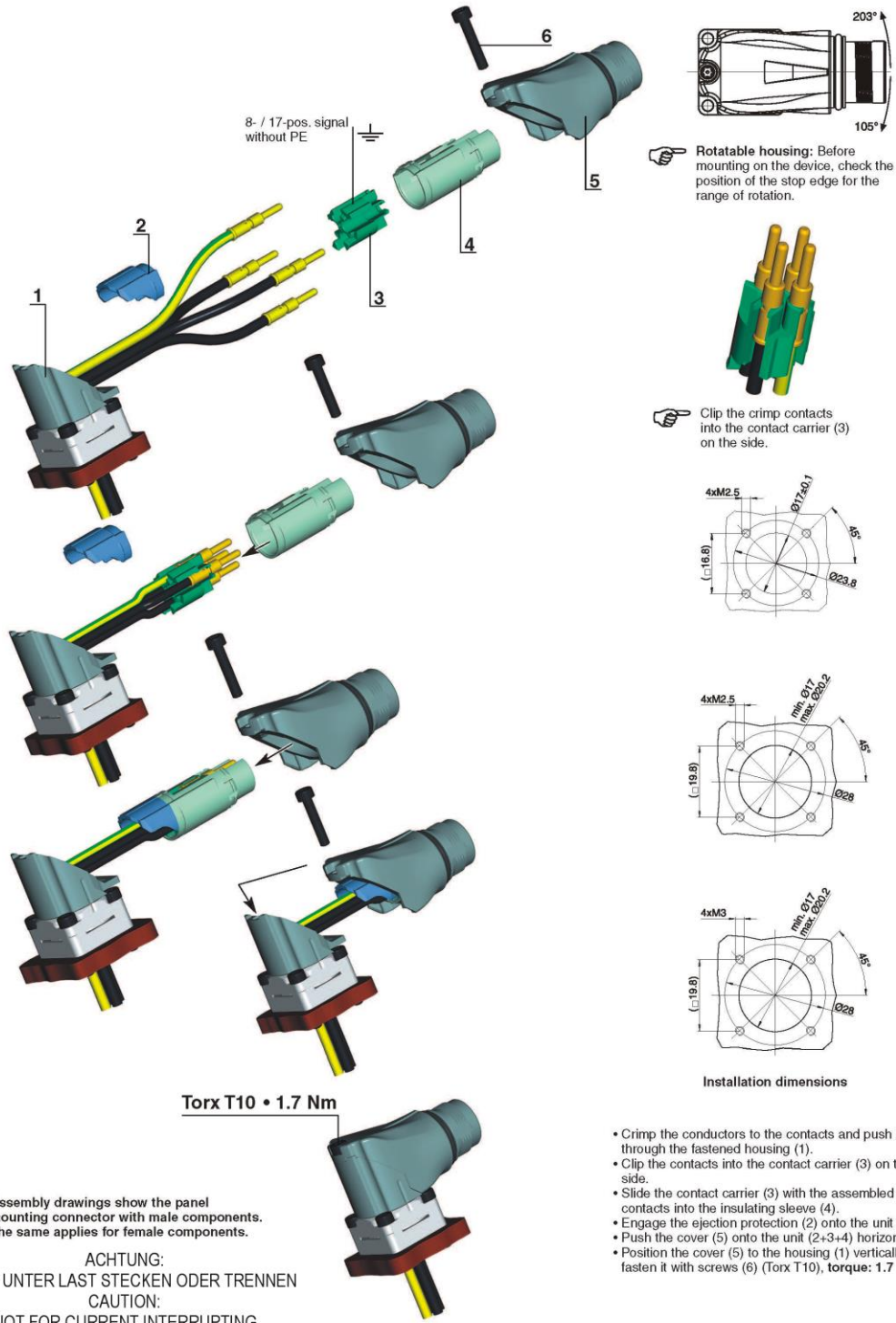

**Rotatable housing:** Before mounting on the device, check the position of the stop edge for the range of rotation.

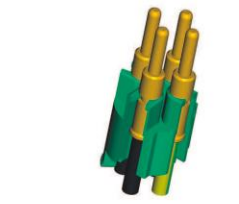

Clip the crimp contacts into the contact carrier (3) on the side.

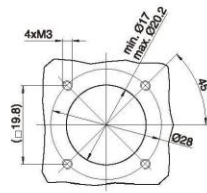
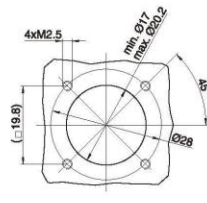
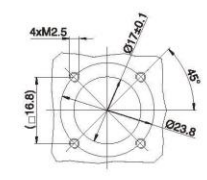

Installation dimensions

Torx T10 • 1.7 Nm

Assembly drawings show the panel mounting connector with male components. The same applies for female components.

**ACHTUNG:**  
NICHT UNTER LAST STECKEN ODER TRENNEN  
**CAUTION:**  
NOT FOR CURRENT INTERRUPTING  
**ATTENTION:**  
NE PAS UTILISER POUR COUPER LE COURANT

- Crimp the conductors to the contacts and push them through the fastened housing (1).
- Clip the contacts into the contact carrier (3) on the side.
- Slide the contact carrier (3) with the assembled contacts into the insulating sleeve (4).
- Engage the ejection protection (2) onto the unit (3+4).
- Push the cover (5) onto the unit (2+3+4) horizontally.
- Position the cover (5) to the housing (1) vertically and fasten it with screws (6) (Torx T10), torque: 1.7 Nm.