

5551 0200	<b>DATA SHEET</b>	
Valid from: 03.07.2018	<b>SILVYN® LTPG-M</b>	

SILVYN® LTPG-M is a Brass-Conduit gland with polyamide sealing for fixed applications. The gland can be used due to his properties in mechanical demanding environments.



**Material:**

Body	Brass, nickel plated
Nut	Brass, nickel plated
Sleeve	Brass, nickel plated
Sealing	Polyamide

**Technical Features:**

Connecting thread	M12x1,5 up to M63x1,5 acc. to EN 60423
Nominal width	NW 10 up to NW 63
Protection class	IP66, IP67, IP68 - 5bar and IP69 acc. to EN 60529
Temperature range	Depending on the used conduit -50°C up to +135°C

**Additional features:**

Free of halogen, lead and phosphorus  
Corrosions resistant

**Reference standards:**



**Suitable conduits:**

SILVYN® LTP

For more information please see our current catalogue. Please do not hesitate to contact our laboratory if there are any questions regarding resistance against aggressive agents and special oil.

Creator: MAU1/PDP Released: DAMU1/PDP	Document: DB55510200EN Version: 03	Page 1 of 2
--	---------------------------------------	-------------

5551 0200	<b>DATA SHEET</b>	
Valid from: 03.07.2018	<b>SILVYN® LTPG-M</b>	

**Product drawing:**

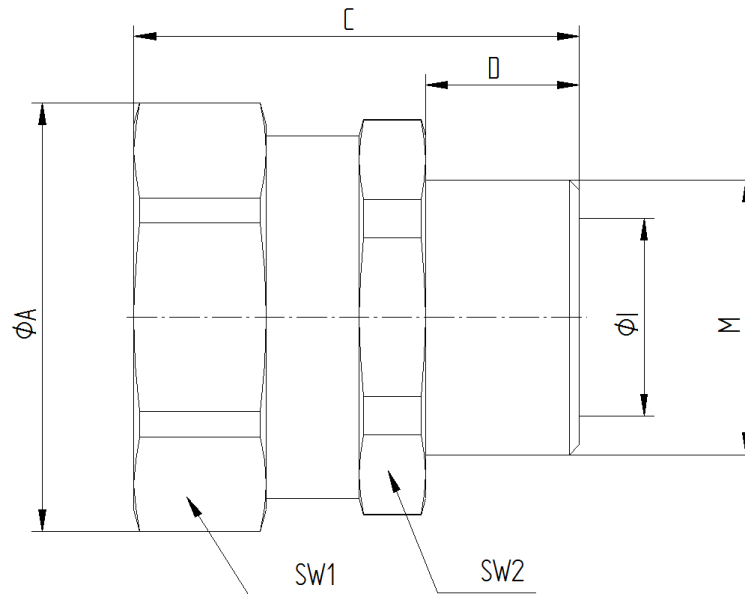

**Dimension table:**

Part No.	Nominal width NW	Thread M	Thread length D mm	Length C mm	Diameter mm		Wrench size		Weight g/piece
					ØI	ØA	SW1	SW2	
5551 0200	10	M12x1,5	10,0	29,8	5,6	22,0	20	20	33
5551 0210	12	M16x1,5	10,0	29,8	8,6	26,0	24	22	35
5551 0220	16	M16x1,5	12,0	33,0	10,7	29,0	26	24	44
5551 0230	16	M20x1,5	12,0	33,0	10,7	29,0	26	24	46,6
5551 0240	20	M20x1,5	12,0	33,5	14,5	32,0	29	26	51,8
5551 0250	25	M25x1,5	14,0	40,5	18,0	39,0	35	33	94,5
5551 0260	32	M32x1,5	15,0	45,8	24,6	46,0	42	40	134
5551 0270	40	M40x1,5	16,0	47,5	32,7	57,0	52	50	209,8
5551 0280	50	M50x1,5	18,0	53,0	37,7	64,0	58	58	273
5551 0290	63	M63x1,5	20,0	58,8	49,0	77,0	70	70	430,9