

55506305	<b>DATA SHEET</b>	
Valid from: 18.07.2019	<b>SILVYN® FPAG-M</b>	

SILVYN® FPAG-M is a conduit gland with a fast fit for a safety assembling.  
 For the demounting we are recommending to use a screwdriver.  
 The gland is suitable for SILVYN® FPAS and can be used in the machine- and plant constructions.



**Material:** PA66

**Technical Features:**  
 Connecting thread M12x1,5 up to M63x1,5  
 Nominal width NW 10 up to NW 67  
 Protection class IP66 acc. to EN 60529  
 In combination with SILVYN® FPAS  
 Temperature range -50°C up to +135°C

**Additional features:**  
 Free of halogen, sulphur and phosphorous  
 UV-Resistant SILVYN® FPAS black

**Colour:** Grey  
 Black

**Approvals:**



**Reference standards:** IEC 61386-1  
 IEC 61386-23

**Suitable conduits:** SILVYN® FPAS

For more information please see our current catalogue. Please do not hesitate to contact our laboratory if there are any questions regarding resistance against aggressive agents and special oil.

Creator: MAU1 /PDP Released: DAMU1/PDP	Document: DB55506305EN Version: 04	Page 1 of 2
-------------------------------------------	---------------------------------------	-------------

55506305	<b>DATA SHEET</b>	
Valid from: 18.07.2019	<b>SILVYN® FPAG-M</b>	

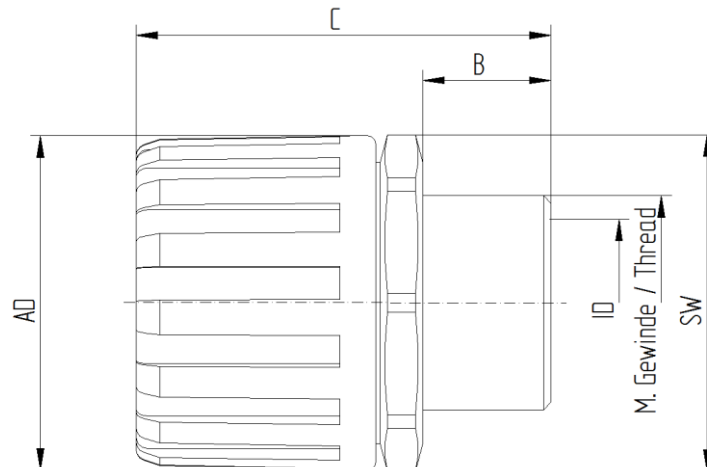

**Dimension table:**

Part No.	NW	Thread	Thread length B mm	Length C mm	Inner Diameter ID mm	Outer Diameter AD mm	SW
<b>SILVYN FPAG-M Grey</b>							
5550 6300	10	M12x1,5	9	33	7,5	19	19
5550 6310	13	M16x1,5	11	37	11,0	24	23
5550 6320	16	M16x1,5	11	41	11,0	29	28
5550 6330	16	M20x1,5	14	44	14,5	29	28
5550 7050	18	M20x1,5	14	44	14,5	32	30
5550 6340	21	M20x1,5	14	44	14,5	32	30
5550 6350	28	M25x1,5	15	49	19,5	44	42
5550 6360	34	M32x1,5	16	53	26,5	51	49
5550 6370	42	M40x1,5	16	60	32,5	63	60
5550 6380	42	M50x1,5	16	60	40,5	63	60
5550 6390	54	M50x1,5	16	65	42,0	76	73
5550 6400	54	M63x1,5	16	65	53,0	76	73
5550 6470	67	M63x1,5	16	70	56,0	90	87
<b>SILVYN FPAG-M Black</b>							
5550 6305	10	M12x1,5	9	33	7,5	19	19
5550 6315	13	M16x1,5	11	37	11,0	24	23
5550 6325	16	M16x1,5	11	41	11,0	29	28
5550 6335	16	M20x1,5	14	44	14,5	29	28
5550 7055	18	M20x1,5	14	44	14,5	32	30
5550 6345	21	M20x1,5	14	44	14,5	32	30
5550 6355	28	M25x1,5	15	49	19,5	44	42
5550 6365	34	M32x1,5	16	53	26,5	51	49
5550 6375	42	M40x1,5	16	60	32,5	63	60
5550 6385	42	M50x1,5	16	60	40,5	63	60
5550 6395	54	M50x1,5	16	65	42,0	76	73
5550 6405	54	M63x1,5	16	65	53,0	76	73
5550 6475	67	M63x1,5	16	70	56,0	90	87