

55506010	<b>DATA SHEET</b>	
Valid from: 03.07.2018	<b>SILVYN® MSK-M ATEX</b>	

The SILVYN® MSK-M ATEX is a multifunction conduit cable gland, which is especially developed for potentially explosive areas. Furthermore SILVYN® MSK-M ATEX is an innovative solution for applications, in which cables and conduits need to be sealed and strain relieved concurrently.



**The multi-conduit cable gland consists of:**

Body	Nickel Plated Brass
O-Ring	Nitrile Rubber (NBR)
PA-Insert	Polyamide (PA 6)
Seal	Polychloroprene-Nitrile Rubber (CR/NBR)
Cap Nut	Nickel plated brass
End Grommet	Nickel Plated Brass
Seal TPE	Thermoplastic Elastomer (TPE)
Screw-Down Nut	Nickel Plated Brass

**Characteristics:**

**Connecting Thread:** Metric, according to EN 50262

**Temperature range:** -30°C up to +90°C

**Protection Rating:** Cable: IP 66 and IP 68 (10bar, 30min)  
Conduit: IP 40 in combination with

- SILVYN® AS
- SILVYN® EDU-AS
- SILVYN® EMC AS-CU
- SILVYN® SSUE
- SILVYN® UI 511

**Approvals:** SILVYN® MSK-M 16x1,5 AS ATEX

- IBExU06ATEX1012X
- II 2G EEx eII
- II 1D EEx eII
- CE 0637 Ex II 2G
- Ex eb IIC Ex II 1D
- Ex ta IIIC
- IECEx IBE 13.0033X

The SILVYN® MSK-M ATEX is a multifunction conduit cable gland, which is especially developed for potentially explosive areas. Furthermore SILVYN® MSK-M ATEX is an innovative solution for applications, in which cables and conduits need to be sealed and strain relieved concurrently.

Creator: M. Wegerer /PDP Released: DAMU1/PDP	Document: DB55506010EN Version: 02	Page 1 of 2
---	---------------------------------------	-------------

55506010	<b>DATA SHEET</b>	
Valid from: 03.07.2018	<b>SILVYN® MSK-M ATEX</b>	

**Suitable Conduits:** SILVYN® AS  
SILVYN® EDU-AS  
SILVYN® EMC AS-CU

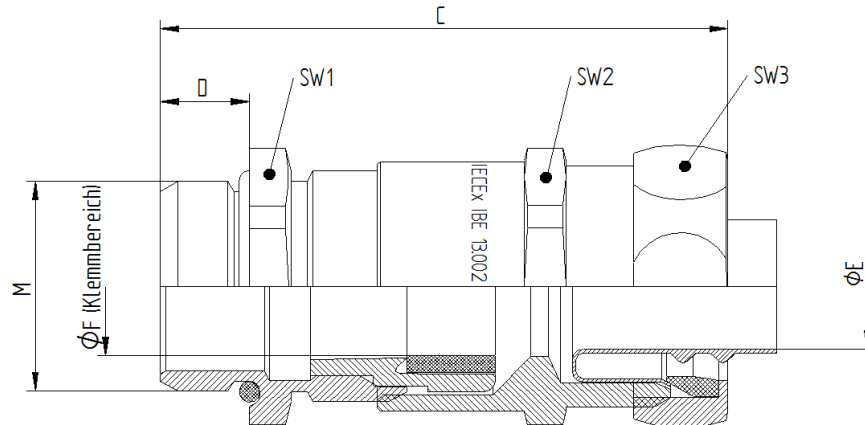

Part No.	Part description	Thread M	Thread length D	ØF	ØE	SW 1	SW 2	SW 3	Length C	Piece/VPE
<b>SILVYN® MSK-M ATEX</b>										
55506010	SILVYN® MSK-M 12x1,5 AS ATEX	M 12	6,5	3 - 7	6,5	16	16	17	43,5	5,0
55506011	SILVYN® MSK-M 16x1,5 AS ATEX	M 16	7	4,5 - 10	10	20	20	21	47	5,0
55506012	SILVYN® MSK-M 20x1,5 AS ATEX	M 20	8,5	7 - 13	12,5	24	24	25	52,5	5,0
55506013	SILVYN® MSK-M 25x1,5 AS ATEX	M 25	8	9 - 17	16,5	29	29	29	55,5	5,0
55506014	SILVYN® MSK-M 32x1,5 AS ATEX	M 32	9	11 - 21	24,5	36	36	36	71,5	5,0
55506015	SILVYN® MSK-M 40x1,5 AS ATEX	M 40	9	19 - 28	29,5	45	45	45	75,5	1,0
55506016	SILVYN® MSK-M 50x1,5 AS ATEX	M 50	10	27 - 35	38	54	54	54	81	1,0
55506017	SILVYN® MSK-M 63x1,5 AS ATEX	M 63	15	34 - 45	49	67	67	66	87	1,0
<b>SILVYN® MSK-M EDU ATEX</b>										
55506018	SILVYN® MSK-M 12x1,5 EDU ATEX	M 12	6,5	3 - 7	6	16	16	17	43,5	5,0
55506019	SILVYN® MSK-M 16x1,5 EDU ATEX	M 16	7	4,5 - 10	8,5	20	20	21	47	5,0
55506036	SILVYN® MSK-M 20x1,5 EDU ATEX	M 20	8,5	7 - 13	11,5	24	24	25	52,5	5,0
55506037	SILVYN® MSK-M 25x1,5 EDU ATEX	M 25	8	9 - 17	15,5	29	29	29	55,5	5,0
55506038	SILVYN® MSK-M 32x1,5 EDU ATEX	M 32	9	11 - 21	20,5	36	36	36	71,5	5,0
55506039	SILVYN® MSK-M 40x1,5 EDU ATEX	M 40	9	19 - 28	27,5	45	45	45	75,5	1,0
55506040	SILVYN® MSK-M 50x1,5 EDU ATEX	M 50	10	27 - 35	36,5	54	54	54	81	1,0
55506041	SILVYN® MSK-M 63x1,5 EDU ATEX	M 63	15	34 - 45	47,5	67	67	66	87	1,0

For more information please see our current catalogue. Please do not hesitate to contact our laboratory if there are any questions regarding resistance against aggressive agents and special oil.

Creator: M. Wegerer /PDP Released: DAMU1/PDP	Document: DB55506010EN Version: 02	Page 2 of 2
---	---------------------------------------	-------------