

55503612	DATA SHEET	
Valid from: 03.07.2018	SILVYN® FCE-S	

SILVYN® FCE-S is a swivelling two-part conduit gland, made of nickel plated brass. The gland is suitable to the protection conduits SILVYN® FCE-V0 and SILVYN® FCE-LFH.



Material:

Body	Nickel plated brass
Sleeve	Nickel plated brass

Technical Features:

Connecting thread	M10x1,0 up to M63x1,5
Nominal wide	NW 10 up to NW 50
Protection class	IP54 acc. to EN 60529
Temperature range	Depending on the used conduit -55°C up to +260°C

Additional features:

Rugged
Corrosion resistant

Color:

Metallic shiny

Approbation:



Reference standards:

EN 61386-1

Suitable conduits:

SILVYN® FCE-V0
SILVYN® FCE-LFH

Creator: MAU1/PDP Released: DAMU1/PDP	Document: DB55503612EN Version: 01	Page 1 of 2
--	---------------------------------------	-------------

55503612	DATA SHEET	
Valid from: 03.07.2018	SILVYN® FCE-S	

Product drawing:

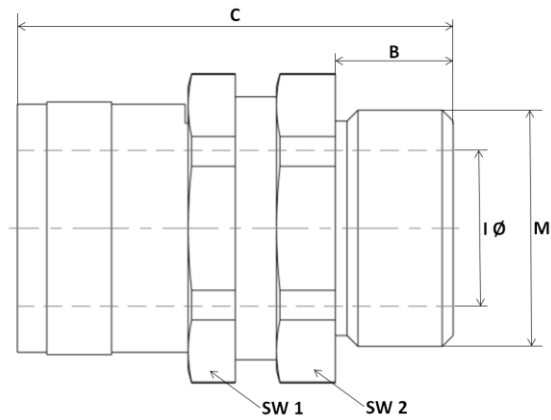

Dimension table:

Part No.	NW	Thread M	Thread length B mm	Inner Diameter I Ø mm	Length C mm	SW 1	SW 2	Weight Kg/100
5550 3612	10	M10x1,0	8	5,5	30	14	14	1,7
5550 3613	10	M12x1,5	8	5,5	30	14	14	1,9
5550 3614	12	M12x1,5	10	8,5	34	18	18	2,4
5550 3615	12	M16x1,5	10	8,5	34	18	18	3,1
5550 3616	16	M16x1,5	10	11,2	36	20	20	3,9
5550 3617	16	M20x1,5	10	11,2	36	20	22	4,2
5550 3618	20	M20x1,5	10	15,2	37	24	24	4,9
5550 3619	25	M25x1,5	12	19,2	43	30	30	8,8
5550 3620	32	M32x1,5	13	25,9	47	38	38	13,3
5550 3621	40	M40x1,5	14	34,8	56	48	48	25,1
5550 3622	50	M50x1,5	15	44,8	60	60	60	36,7
5550 3623	50	M63x1,5	16	44,8	61	60	70	47,1

For more information please see our current catalogue. Please do not hesitate to contact our laboratory if there are any questions regarding resistance against aggressive agents and special oil.

Creator: MAU1/PDP Released: DAMU1/PDP	Document: DB555036 12EN Version: 01	Page 2 of 2
--	--	-------------