

| | | |
|---------------------------|--------------------------|---|
| 61806690 | DATA SHEET |  |
| Valid from: 11.02.2020 | SILVYN® SPLIT COS | |

SILVYN® SPLIT COS is a conduit holder made of polyamide for the SILVYN® SPLIT. The one-hole attachment will be obtained by an integrated fin, fixing the conduit in axial direction.

Processing: The conduit holder is quick to assembling by one mounting hole. Conduit is locking by just pressing in the holder.



| | |
|----------------------------|--------------------|
| Material: | PA 6 |
| Technical Features: | |
| Fixing screw | M3, M5 and M6 |
| Nominal width | NW 6 up to NW 70 |
| Temperature range | -45°C up to +120°C |

| | |
|--------------------------------|-----------------|
| Additional features: | |
| Fire classification | V2 acc. to UL94 |
| Free of Halogen and cadmium | |
| Resistant to UV and weathering | |

Color: Black

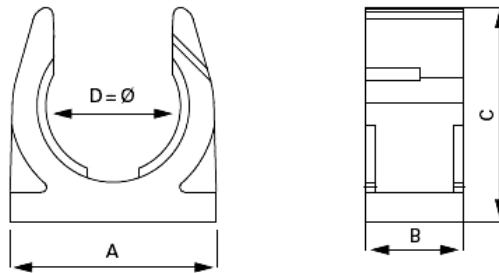

Dimension table:

| Part No. | Part name | NW | Screw Ø mm | Wide A mm | Length B mm | High C mm | Diameter D mm |
|--------------|------------------------|----|------------|-----------|-------------|-----------|---------------|
| Black | | | | | | | |
| 6180 6693 | SILVYN SPLIT COS 6 BK | 6 | M3 | 15 | 20 | 17,5 | 9,7 |
| 6180 6690 | SILVYN SPLIT COS 10 BK | 10 | M3 | 18,5 | 20 | 17,5 | 13,5 |
| 6180 6676 | SILVYN SPLIT COS 10 BK | 10 | M5 | 18,5 | 20 | 17,5 | 13,5 |
| 6180 6694 | SILVYN SPLIT COS 11 BK | 11 | M3 | 21 | 20 | 22,5 | 16 |
| 6180 6700 | SILVYN SPLIT COS 14 BK | 14 | M3 | 24 | 20 | 27,5 | 18,7 |
| 6180 6677 | SILVYN SPLIT COS 14 BK | 14 | M5 | 24 | 20 | 27,5 | 18,7 |
| 6180 6695 | SILVYN SPLIT COS 16 BK | 16 | M5 | 30 | 20 | 35 | 21,6 |
| 6180 6696 | SILVYN SPLIT COS 16 BK | 16 | M6 | 30 | 20 | 35 | 21,6 |
| 6180 6710 | SILVYN SPLIT COS 20 BK | 20 | M5 | 35 | 20 | 38 | 26 |
| 6180 6678 | SILVYN SPLIT COS 20 BK | 20 | M6 | 35 | 20 | 38 | 26 |
| 6180 6720 | SILVYN SPLIT COS 23 BK | 23 | M5 | 41,6 | 20 | 43 | 31,3 |
| 6180 6679 | SILVYN SPLIT COS 23 BK | 23 | M6 | 41,6 | 20 | 43 | 31,3 |
| 6180 6697 | SILVYN SPLIT COS 29 BK | 29 | M5 | 48 | 20 | 50,5 | 35,3 |
| 6180 6698 | SILVYN SPLIT COS 29 BK | 29 | M6 | 48 | 20 | 50,5 | 35,3 |
| 6180 6730 | SILVYN SPLIT COS 37 BK | 37 | M6 | 56 | 20 | 56,6 | 41,8 |
| 6180 6740 | SILVYN SPLIT COS 45 BK | 45 | M6 | 67 | 20 | 68 | 54 |
| 6180 6699 | SILVYN SPLIT COS 70 BK | 70 | M6 | 100 | 20 | 100 | 79,8 |

For more information please see our current catalogue. Please do not hesitate to contact our laboratory if there are any questions regarding resistance against aggressive agents and special oil.

| | | |
|---|---------------------------------------|-------------|
| Creator: MAU1 /PDP Released: DAMU1/PDP | Document: DB61806690EN Version: 07 | Page 1 of 1 |
|---|---------------------------------------|-------------|