

55503476	<b>DATA SHEET</b>	
Valid from: 03.07.2018	<b>SILVYN® LCC CONNECTOR</b>	

The SILVYN® LCC Connector is a conduit coupler, for the extension of conduits.

- Material:** Body – Nickel plated brass  
Seal – Elastomer
- Features** High tensile strength  
Resistant to oil  
Corrosion resistant  
Chemical resistant  
Conforms to DIN EN 61386-23



**Temperature range:** -50°C up to +135 °C

**Note:** Free of halogen, Sulphur and Phosphorous

**Protection class:** IP 65

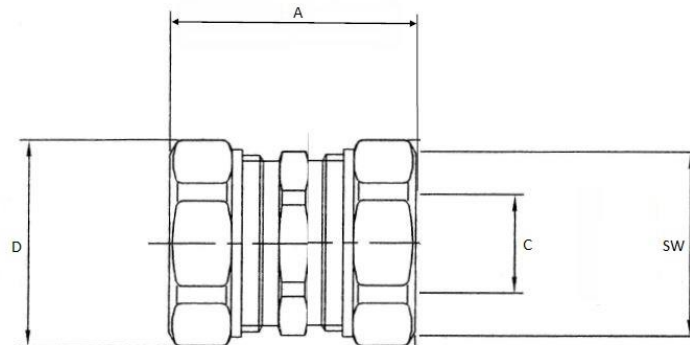

**Dimension table:**

Part No.	Part name	Nominal size	Length A mm	Inner Ø C mm	Outer Ø D mm	SW
5550 3476	SILVYN® LCC Connector	16	39,0	11,5	26	24
5550 3477	SILVYN® LCC Connector	20	39,5	15,3	29	26
5550 3478	SILVYN® LCC Connector	25	46,9	19,1	35	33
5550 3479	SILVYN® LCC Connector k	32	56	26	42	40

For more information please see our current catalogue. Please do not hesitate to contact our laboratory if there are any questions regarding resistance against aggressive agents and special oil.

Creator: M. Wegerer /PDP Released: DAMU1/PDP	Document: DB55503476EN Version: 01	Page 1 of 1
---	---------------------------------------	-------------